

Chorley
Council

Planning
Committee Meeting

05 October 2021



Item 3b and 3c

20/01211/FULMAJ & 20/00176/LBC

The Great Barn, Hoghton Tower

Conversion of Great Barn (building 17) to wedding venue (sui generis) and ancillary use of outbuildings (buildings 1-16), including the flexible use of outbuildings within class E (E(a), E(b), E(c)(i), E(c)(ii) and E(g)(i). Reinstatement of building 5 and the temporary siting of portable toilets and catering facilities to rear of Great Barn.

Location Plan

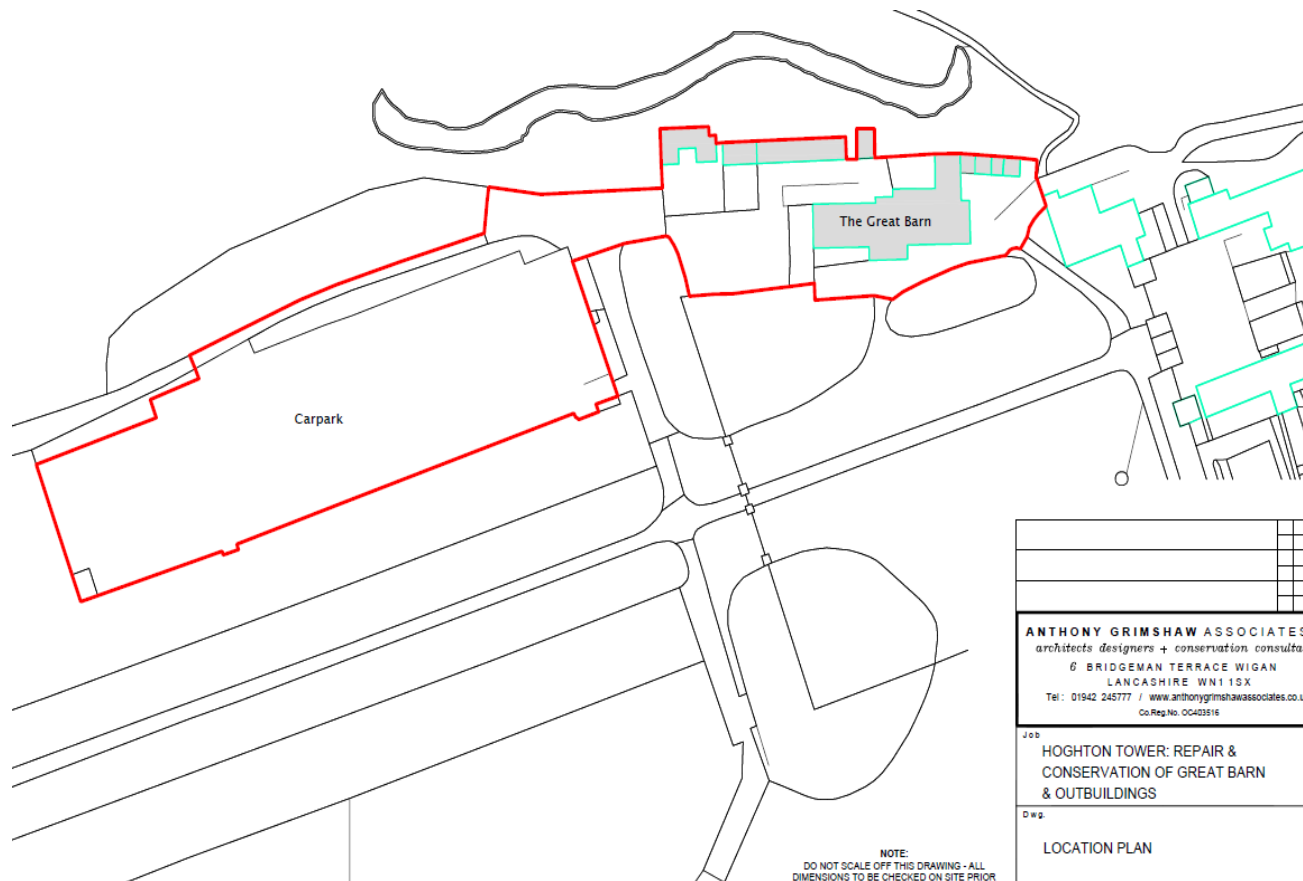

ANTHONY GRIMSHAW ASSOCIATES architects designers + conservation consultant 6 BRIDGEMAN TERRACE WIGAN LANCASHIRE WN1 1SX Tel: 01942 245777 / www.anthonygrimshawassociates.co.uk Co.Reg.No. 00403616	
Job:	HOGHTON TOWER: REPAIR & CONSERVATION OF GREAT BARN & OUTBUILDINGS
Dwg:	LOCATION PLAN

Aerial photo

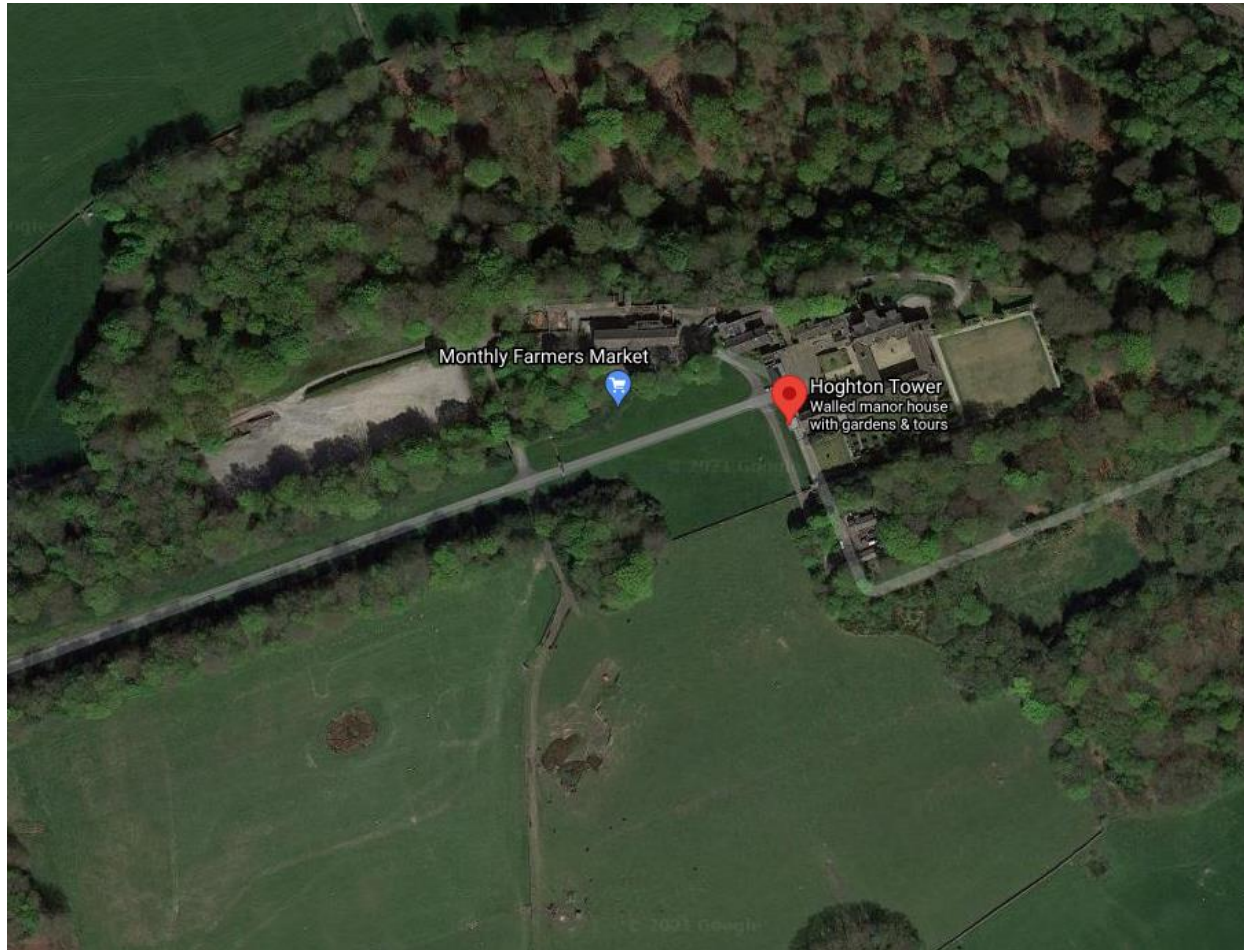

ocation

Site Photo



Site Photo



Site Photo



Site Photo

